

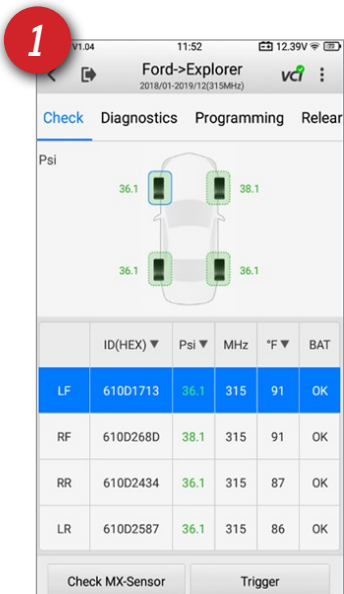

# QUICKSTARTGUIDE

## ITS600 & TBE200 CONNECTION, DIAGNOSTICS, PROGRAMMING & RELEARN



### STEP ONE

Pair the VCI200 with the TBE200, Insert the dongle into the Vehicle's diagnostic port then select the year, make and model from the main menu. Activate all sensors in the order indicated in the "Check" Function with the "trigger" button

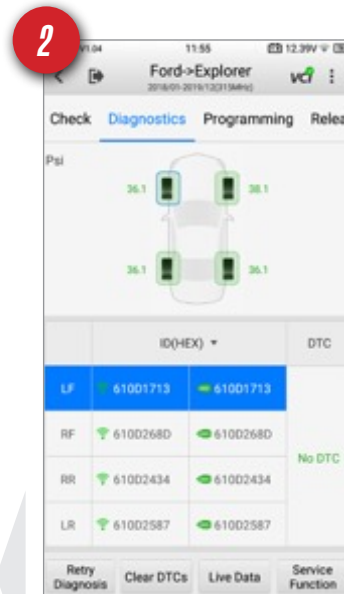

### STEP TWO

After activating each TPMS sensors with the "Trigger" button, tap the "Diagnostics" tab to perform a TPMS Diagnose. The tool will then compare the physical location of the sensors and ID'S with the module information.



### STEP THREE

After performing the diagnosis, tap the programming tab to create replacement Autel MX-Sensors. The sensors MUST be programmed prior to installation to perform correctly. Choose the programming method and place the sensor near the top of the tool.

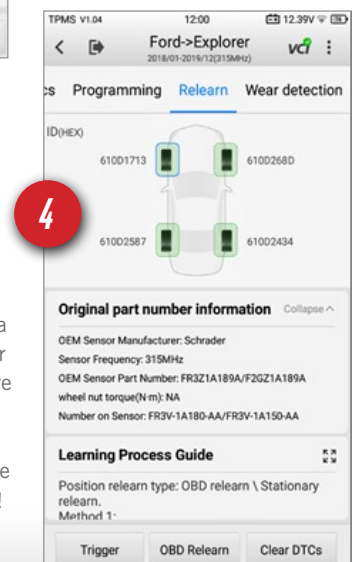

### STEP FOUR

Tap the relearn tab to execute a tpms relearn. The directions for each vehicle's relearn procedure will be provided to minimize errors. If there is more than one method it will be indicated. The TPMS service is now complete!



TEL: 1.855.288.3587 | WEB: AUTEL.COM  
 EMAIL: USSUPPORT@AUTEL.COM | AUTEL.COM  
 FOLLOW US @AUTELTOOLS





# QUICKSTARTGUIDE

## ITS600 & TBE200 CONNECTION & PARING OF TBE200

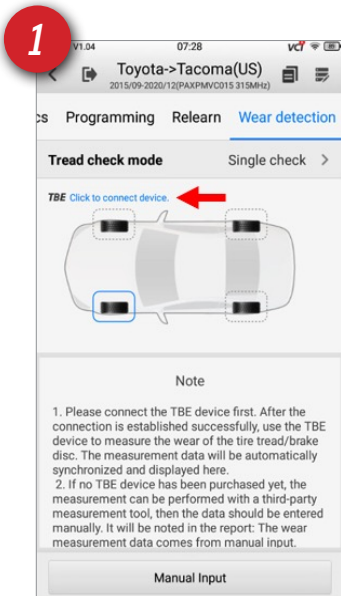

### STEP ONE

Verify that both the ITS600 & TBE are connected to the same Wi-Fi network. Tap the Wear Detection tab. Tap "TBE Click to connect device." Tap the Device displayed on the screen to connect the TBE200 to the ITS600

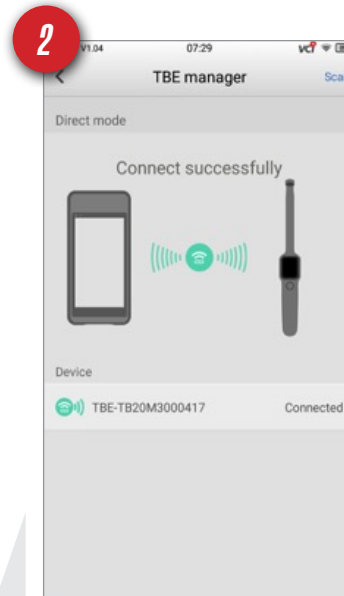

### STEP TWO

The 2 tools are now connected successfully. You can now begin tire tread depth measurements with THE TBE200. The values will be displayed on the ITS600 along with service recommendations and wear information.



### STEP THREE

Tap "Tire Tread" on the TBE200 to begin using measuring tire tread depth. The values will appear on the ITS600 as well as the TBE200. The tread depth data will now integrate with the TPMS related information on the ITS600. The data can be printed and presented on a scan report

### STEP FOUR

The inner middle and outer sections of adjacent tread blocks are measured to get the most accurate information regarding tread wear. The tool can identify uneven wear characteristics. Single or All Check Mode can be selected in the "Check Settings Menu

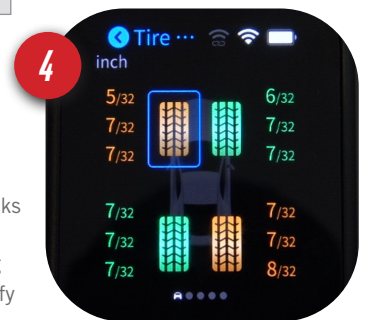

TEL: 1.855.288.3587 | WEB: AUTEL.COM  
EMAIL: USSUPPORT@AUTEL.COM AUTEL.COM  
FOLLOW US @AUTELTOOLS



SCAN TO WATCH  
TRAINING VIDEOS  
YouTube



AUTEL®

# QUICKSTARTGUIDE

## TPMS VEHICLE HEALTH & TBE200 REPORT

Basic information	Customer information	Vehicle information
Workshop name:AAA Tires Tel:303-555-1234 Email: Website: Address:1234 First St.	Customer:Leo H.	License: Vin:1GCVKPEH6HZ407481 Make/Model:Chevrolet Silverado Year:2016/11-2019/12(315MHz)
Time (Y/M/D):2021/06/12 Service & Repairs needed		Device:ITS600/V1.04,TBE200/V01.08.00
<input type="checkbox"/> TPMS sensor replacement	<input type="checkbox"/> Position relearn	<input checked="" type="checkbox"/> Tire pressure adjustment
<input type="checkbox"/> Tire repair	<input checked="" type="checkbox"/> Tire replacement	<input type="checkbox"/> Brake disc replacement
<input type="checkbox"/> Tire rotation	<input type="checkbox"/> Seasonal tire swap	<input checked="" type="checkbox"/> Wheel alignment
Other:		

Vehicle Summary Status	Diagnostics	Tire Tips
	<b>DTC information</b> ODTCs:	Tires should be rotated every six months, or 6,000 to 8,000 miles (10,000 to 12,000 km) or as specified by your vehicle manufacturer.

### Left front wheel

78CD1B8D 78CD1B8D Match	Sensor status Pass OK	Tire pressure 42.0Psi Normal	Temperature 111°F Normal
	Tire brand:Federal Tire Tire specification:265/55R20 114S Tire DOT:		
Tire condition:Irregular wear			
<b>Maintenance suggestions:</b> 1.Tires:Check chassis parts for deformation and looseness, and then check 4-wheel alignment parameters. 2.Brake disc:Normal;Check brake disc regularly.			

### Right front wheel

78CD212B 78CD212B Match	Sensor status Pass OK	Tire pressure 41.0Psi Normal	Temperature 109°F Normal
	Tire brand: Tire specification:265/55R20 114S Tire DOT:		
Tire condition:Worn			
<b>Maintenance suggestions:</b> 1.Tires:Replace tire immediately. 2.Brake disc:Normal;Check brake disc regularly.			

### Right rear wheel

78CCF737 78CCF737 Match	Sensor status Pass OK	Tire pressure 36.0Psi Normal	Temperature 100°F Normal
	Tire brand:Federal Tire Tire specification:265/55R20 114S Tire DOT:		
Tire condition:Worn			
<b>Maintenance suggestions:</b> 1.Tires:Replace tire immediately. 2.Brake disc:Normal;Check brake disc regularly.			

### Left rear wheel

78CD20CA 78CD20CA Match	Sensor status Pass OK	Tire pressure 42.0Psi Normal	Temperature 98°F Normal
	Tire brand:Federal Tire Tire specification:265/55R20 114S Tire DOT:		
Tire condition:Worn			
<b>Maintenance suggestions:</b> 1.Tires:Replace tire immediately. 2.Brake disc:Normal;Check brake disc regularly.			

Gray: Unchecked; Green: Normal; Yellow: Alert! Replacement recommended; Red: Abnormal! Immediate replacement.



TEL: 1.855.288.3587 | WEB: AUTEL.COM  
EMAIL: USSUPPORT@AUTEL.COM AUTEL.COM  
FOLLOW US @AUTELTOOLS



SCAN TO WATCH  
TRAINING VIDEOS  
YouTube



AUTEL®

©2021 Autel U.S. Inc., All Rights Reserved